

## Idle Control Tester ICT68

The EDEA ignition tester is a hand held test tool for diagnosing EFI vehicles and components.

Diagnose vehicles that are:

- Misfiring
- Stalling
- Not starting
- Idling poorly

The EDEA tester can be used on or off car to:

- Drive Stepper Motors.
- Drive Servo Motors
- Drive Idle air bypass devices
- Resetting base idle
- Resolving Vehicle Idle issues

*“EDEA does amazing things with your EFI system”*

Full colour manual with easy to follow pinouts

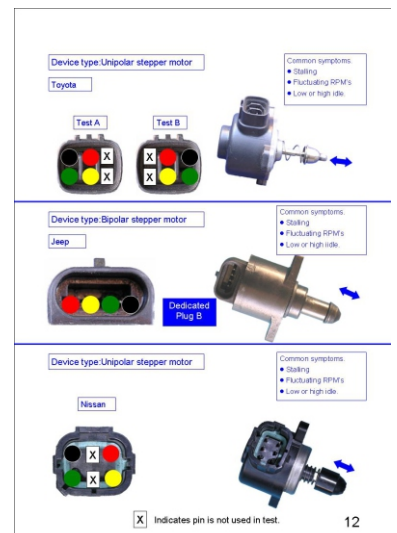
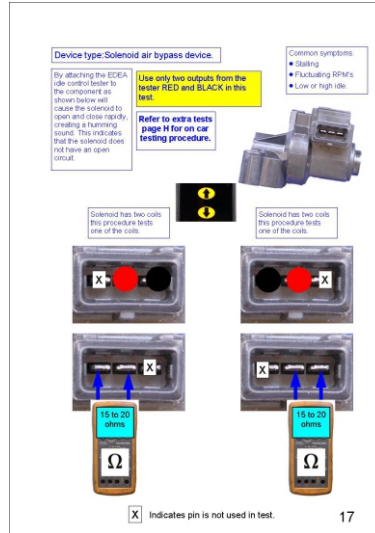
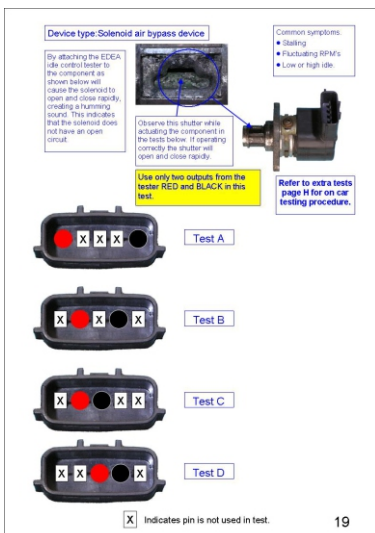

# Idle Control Tester IMT45

## Special Features:

- 31page full colour manual with pinouts and testing procedures
- Adjustable speed settings to drive components in small increments
- Supplied with two dedicated leads to test mitsubishi, GM and korean Vehicles
- Very effective for setting base idle on vehicles with stepper type Idle control
- Supplied with universal leads for testing all idle control devices

*“EDEA does amazing things with your EFI system”*

Part Number ICT68

Sold by:

Technical Support: 0418 687 145